

1 LIGHT DUTY ASPHALT PAVEMENT
SCALE: NTS

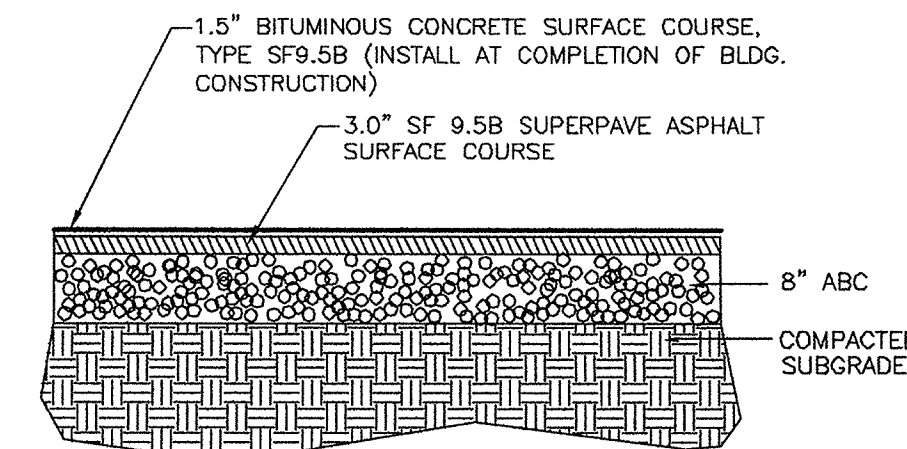

2 HEAVY DUTY ASPHALT PAVEMENT
SCALE: NTS

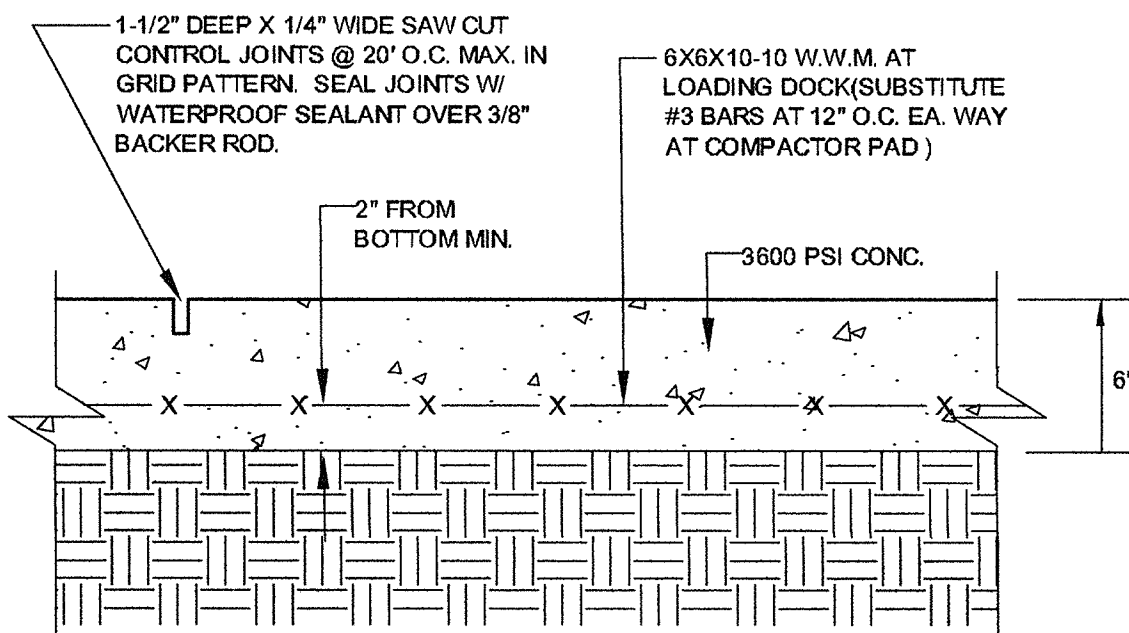

3 CONCRETE PAVEMENT AT LOADING AREA
SCALE: NTS

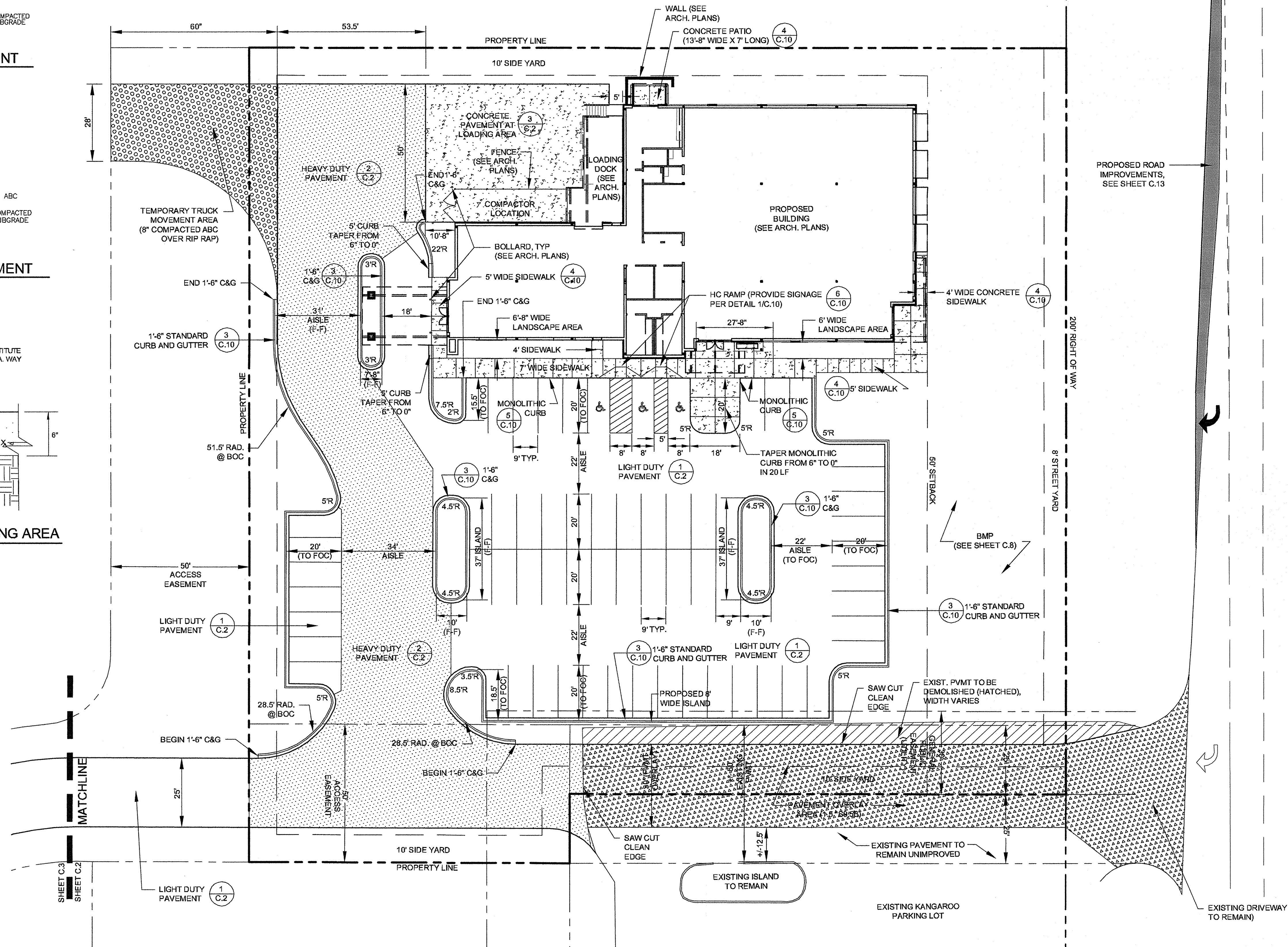

PAVEMENT LEGEND

- CONCRETE PAVING
- HEAVY DUTY PAVEMENT
- TEMPORARY GRAVEL
- PAVEMENT OVERLAY AREA (1.5" S9.5B)
- EXISTING PAVEMENT TO BE DEMOLISHED

SITE NOTES

1. SEE SHEET FOR ACCESSIBLE CURB RAMP AND SIGNAGE.
2. ALL STREET SIGNAGE SHALL CONFORM TO NCDOT STANDARDS.
3. PARKING SPACES SHALL BE 9.0' WIDE X 20.0' LONG MINIMUM, UNLESS NOTED OTHERWISE; ACCESSIBLE PARKING SPACES SHALL BE 8.0' WIDE. SPACES AT END OF ROWS ARE MEASURED TO FACE OF CURB (9' WIDE MEASURED FROM PARKING STRIPE TO FACE OF CURB).
4. DIMENSIONS ARE TO FACE OF CURB TYPICAL, UNLESS NOTED OTHERWISE.
5. RADIUS LABELS INDICATE RADIUS AT BACK OF CURB
6. CONTACT THE UTILITY COMPANY TO RELOCATE ANY EXISTING UTILITY POLES.
7. SEE SHEET C.9 FOR IRRIGATION SLEEVE LOCATIONS

SITE DATA

GENERAL INFORMATION

PROJECT NAME: GOODWILL RETAIL STORE
 TAX PARCEL #: 093-36-006 (OVERALL TRACT, NEW # PENDING)
 OWNER: PIEDMONT COMPANIES, INC
 2667 E. MAIN ST., LINCOLNTON NC, 28092
 PH. 704-736-4330 FAX #: 704-736-4385
 EXISTING ZONING: GB (GENERAL BUSINESS)
 JURISDICTION: CITY OF MONROE, NORTH CAROLINA
 PROPOSED USES: COMMERCIAL
 SITE AREA: 1.89 ACRES
 FEMA PANEL #: NA

PARKING REQUIREMENTS:

PARKING: 63 SPACES PROVIDED
 (1 SPACE / 180 SF +/-)

LANDSCAPE SCREENING, OPEN SPACE:
 SEE LANDSCAPE PLAN (SHEET C.7) FOR REQUIRED
 LANDSCAPING AND SCREENING

MINIMUM SETBACK: 50' (ALONG ROOSEVELT BOULEVARD)
 MINIMUM SIDE YARD: 10'
 MINIMUM REAR YARD: 10'
 MAXIMUM BUILDING HEIGHT: 50'

SITE PLAN

SCALE: 1"=20'

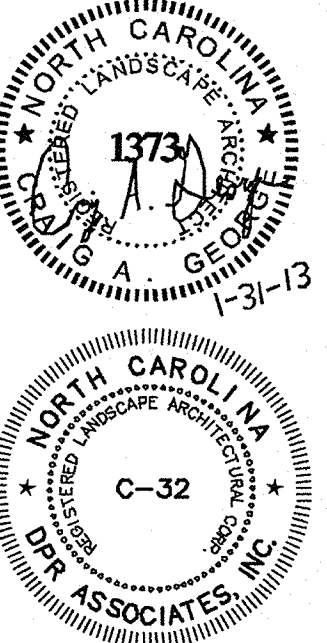
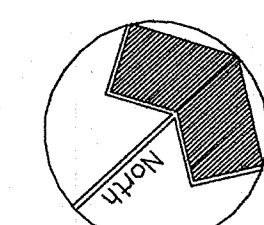
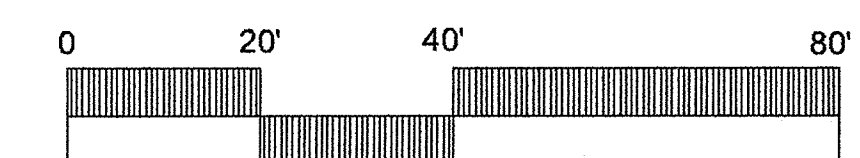

US HIGHWAY 74
 (PROPOSED TRUCK LANE)
 200' PUBLIC RIGHT-OF-WAY
 PC 5, PG. 82
 DE, 3813, PG. 314
 150' PUBLIC RIGHT-OF-WAY
 PC 6, PAGE 428

222 N. LAFAYETTE ST., SUITE 21
 SHELBY, NORTH CAROLINA 28150
 ph. (704) 487-8578
 fax (704) 487-8579
**HOLLAND
 HAMRICK**
 ARCHITECTS, P.A.
 WWW.H-HARCHITECTS.COM

PROJECT TITLE
GOODWILL RETAIL STORE
 MONROE, NORTH CAROLINA