

FLOOR PLAN
1/8" = 1'-0"

LIFE SAFETY PLAN
1/16" = 1'-0"

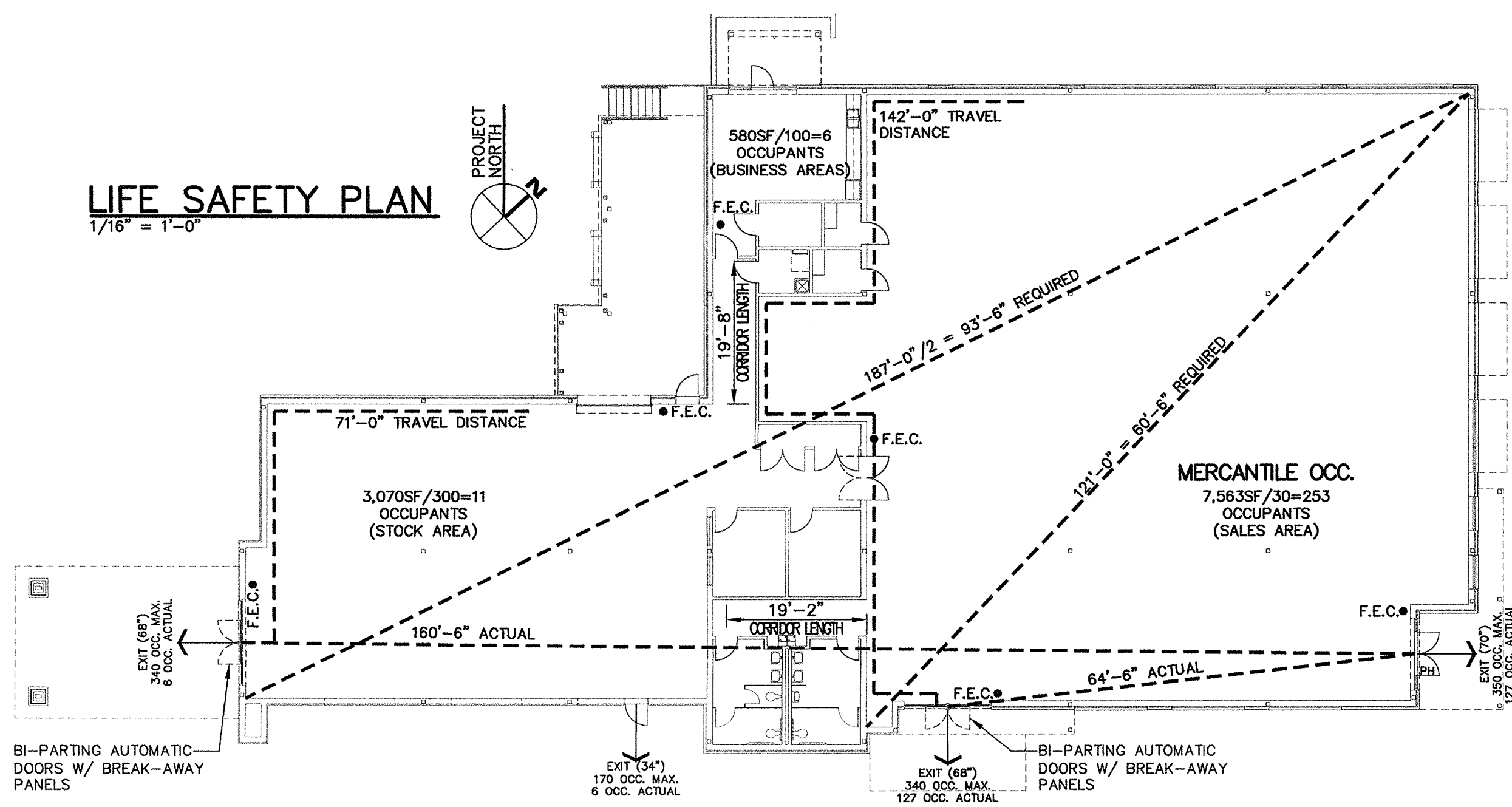

LIFE SAFETY LEGEND

- F.E.C. FIRE EXTINGUISHER & CABINET.
- EXIT (WIDTH) BUILDING EXIT
- EXIT (MAX. OCC. LOAD MAX. OCC. LOAD ACTUAL)
- DOOR(S) W/PANIC HARDWARE

FLOOR PLAN LEGEND

- LINE INDICATES AREAS W/BRICK BELOW.
- 8"x20GA. STEEL STUDS @ 16" O.C. W/ 1/2" GYPSUM BD. (INTERIOR), 1/2" EXTERIOR GYPSUM SHEATHING (EXTERIOR) & 2" EFIS SYSTEM. (11A')
- 8"x20GA. STEEL STUDS @ 16" O.C. W/ 1/2" GYPSUM BD. (INTERIOR), 1/2" EXTERIOR GYPSUM SHEATHING (EXTERIOR) & 4" PAINTED SPLIT FACE CMU VENEER. (1'-2 3/4")
- 8"x20GA. STEEL STUDS @ 16" O.C. W/ 1/2" GYPSUM BD. (INTERIOR), 1/2" EXTERIOR GYPSUM SHEATHING (EXTERIOR) & 4" MODULAR BRICK VENEER. (1'-2 3/4")
- 3 3/4"x20GA. STEEL STUDS @ 16" O.C. W/ 1/2" GYP. BD. EACH SIDE. SEE DETAIL 1/A6.1
- 8"x20GA. STEEL STUDS @ 16" O.C. W/ 1/2" GYP. BD. EACH SIDE. SEE DETAIL 2/A6.1

GENERAL PLAN NOTES:

- SEE SHEET A1.2 FOR GENERAL PROJECT NOTES.
- 1. DOOR JAMBS TO BE 4" OFF ADJACENT WALL OR CENTERED IN ROOM TYP. U.N.O. (STEEL STUD WALLS)
- 2. EXTERIOR WALL DIMENSIONS ARE FROM THE EXTERIOR FACE OF THE MASONRY VENEER OR EFIS TO THE INTERIOR FACE OF THE GYPSUM BD. (U.N.O.)
- 3. INTERIOR PLAN DIMENSIONS ARE FROM THE CENTER OF ALL INTERIOR STEEL STUD WALLS IN RESTROOMS.
- 4. INSTALL SOUND ATTENUATION INSULATION FULL HEIGHT OF ALL INTERIOR STEEL STUD WALLS IN RESTROOMS.
- 5. PROVIDE 1/2" IMPACT RESISTANT GYPSUM BD. TO +8'-0" A.F.F. & (2) 2X8 WALL PROTECTION ON ALL WALLS IN RECEIVING 104. SEE DET. 1/D1.3. 3/8" GYPSUM BD. TO CONTINUE TO STRUCTURE ABV.
- 6. PROVIDE 3/4" PLYWOOD TO 8'-0" A.F.F. IN ELECTRICAL 112 & DATA 114. 1/2" GYPSUM BD. TO CONTINUE TO CEILING ABV.
- 7. PAINT ALL EXTERIOR EXPOSED STEEL W/ EPOXY PAINT (COLOR AS SELECTED BY ARCHITECT).
- 8. ALL GYPSUM BD. APPLICATIONS. SEE DETAIL 10/A6.1.
- 9. PROVIDE MASONRY CONTROL JOINTS (MCJ) AS SHOWN ON PLANS. SEE DETAIL 11/A6.1.
- 10. PROVIDE WATER RESISTANT GYP. BD. ON ALL STEEL STUD WALLS IN AREAS WITH SINKS OR TOILETS.
- 11. ALL APPLIANCES ARE FURNISHED B.O. & INSTALLED BY G.C.
- 12. ALL EXTERIOR RAILINGS TO BE POWDER COATED ALUMINUM. (3/8" THK. POSTS & RAILS) (1/2" THK. PICKETS)

PLAN NOTES

- 1 CASH WRAP BY OWNER. COORDINATE ALL RELATED FIXTURES & DEVICES
- 2 GRAPHIC FIXTURE PANELS BY OWNER.
- 3 FIXED LADDER WITH 30"x36" ROOF ACCESS HATCH. SEE DETAIL 8/A6.1. SEE SPECS.
- 4 COMPUTER KIOSK & TIME CLOCK BY OWNER. G.C. TO COORDINATE BLOCKING & UTILITIES.
- 5 KM7230 DOCK LEVELER W/ INTEGRAL BUMPERS BY KELLEY DOCK SYSTEMS. EQUALS BY BLUE GIANT, W.B. MCGUIRE & RITE HITE.
- 6 4"x3'-6" HIGH STEEL PIPE W/ 6"x6"x1/4" BASE PLATE W/ (5) EMBED STUDS. PROVIDE REMOVABLE CHAIN BETWEEN ALL PIPES.
- 7 VENDING MACHINES BY OWNER. G.C. TO COORDINATE UTILITIES.
- 8 8'-0" HIGH TRAILAGE SCREEN BY GREEN SCREEN.
- 9 DRESSING BENCH. SEE ELEVATION 2/A8.1.
- 10 METAL LOCKERS BY OWNER. G.C. TO COORDINATE BLOCKING.
- 11 4'-0"x4'-0" FCM CURB MOUNTED SKYLIGHT BY VELLUX (ABOVE) W/CLEAR OVER WHITE INSULATED, LOW-E GLAZING. EQUALS BY: ANDERSON, BRISTOL FIBERITE INDUSTRIES, EXARC, NATURALITE & SUNLGO.
- 12 8'-0" VINYL COATED CHAIN LINK FENCE W/ 12'-0" GATE. SEE SPECS.
- 13 TRASH RECEPTACLE. MODEL TR-12 BY FAIRWEATHER. (SEMI-GLOSS BLACK)
- 14 BENCH. MODEL PL-3, PLAZA SERIES BY FAIRWEATHER. (SEMI-GLOSS BLACK)
- 15 BOLLARD. SEE DET. 12/A6.1

CONSULTANT

222 N. LAFAYETTE ST. SUITE 21
SHELBY, NORTH CAROLINA 28150
PH. (704) 487-8576
FAX (704) 487-8579
WWW.H-HARCHITECTS.COM

**HOLLAND
HAMRICK**
ARCHITECTS, P.A.

PROJECT TITLE: **GOODWILL
RETAIL STORE**
Monroe, North Carolina

COM. NO. 2205
DATE 01-31-13
REVISIONS
SHEET **A1.1**
2 OF 15